

 360 properties



TO LET

30 Eastfield Road, Aylesbury, HP20 1PA

£1,700 Per Month



THE PROPERTY

Available from 6th July 2026 is this charming end-terrace house on Eastfield Road in the desirable Broughton area of Aylesbury. This delightful property features one reception room, three bedrooms, and a well-appointed bathroom, providing comfortable living spaces for you and your family.

Built in 1980, this lovely home offers 915 sq ft of space, perfect for both relaxation and entertaining. The three bedrooms are versatile, ideal for a home office, guest room, or extra space for your growing family.

Located in the sought-after area of Broughton, you'll enjoy a peaceful setting while being close to all transport links, including easy access to the A41.

Available immediately, this property offers the chance to move in quickly and start enjoying everything this wonderful home has to offer. Don't miss out on the opportunity to make this rented property your own and create lasting memories in this fantastic location.

For viewings please email agent

Unfurnished
Deposit £1961
Council Tax Band C

SITUATION

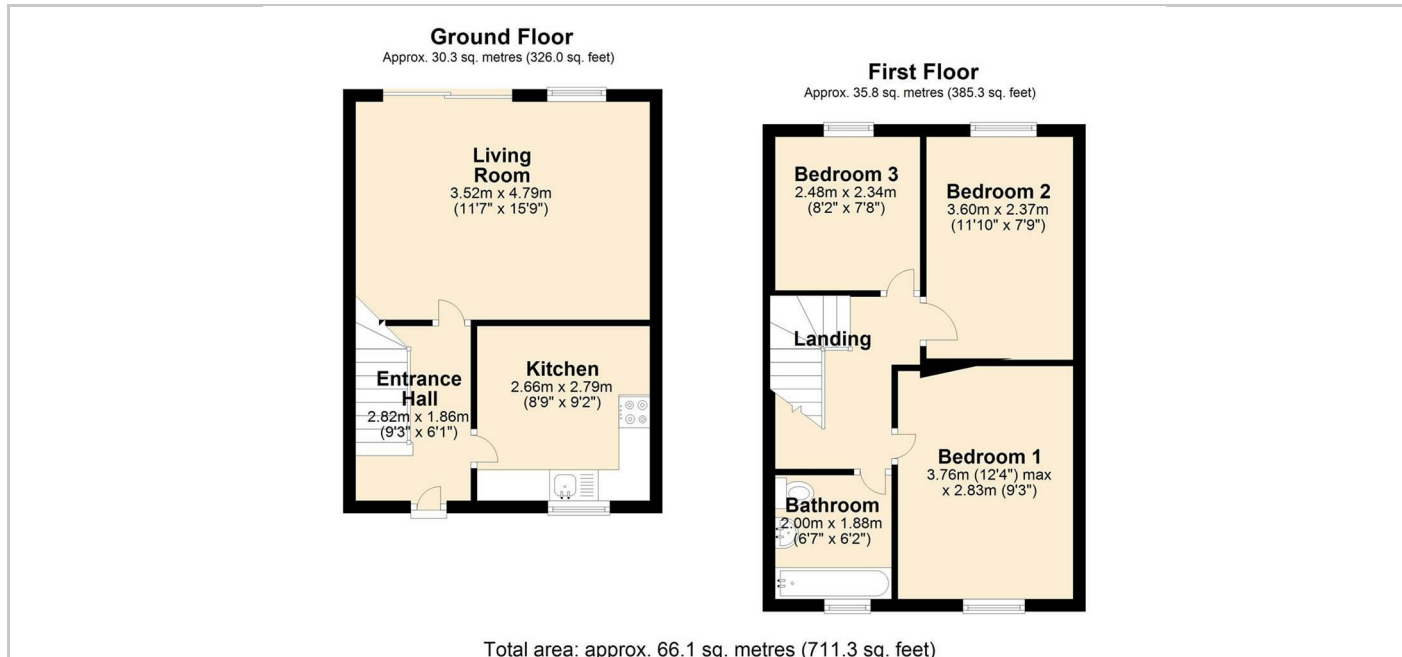

Directions

Market House Market Sq, Aylesbury, HP1201TN

Tel: 01296 767555 Email: francis@360-properties.co.uk <https://www.360-properties.co.uk>